

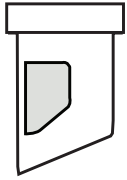

HOW TO REMOVE AND REPLACE A GEHL'S 2.0 VALVE:



If no sauce is flowing from the dispenser and the dispensing button does not push in easily, you may have a stuck valve. This can be easily fixed by replacing the valve.

To get started, have a disposable valve from the product case ready. Unwrap the valve from the plastic overwrap, careful not to expose the valve to contamination.

STEPS TO REMOVE AND REPLACE A GEHL'S 2.0 VALVE:

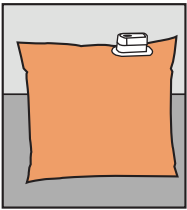

1. Remove the bag of sauce from the dispenser and place on a hard surface with the valve facing upward.

CAUTION: BAG WILL BE HOT.

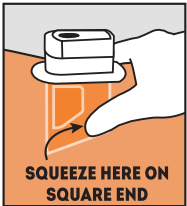

2. Grab the bag directly under the spout. Through the bag, squeeze the sides of the valve together at the square end, gently pushing upward.

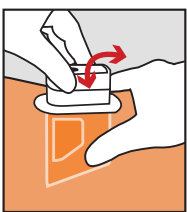
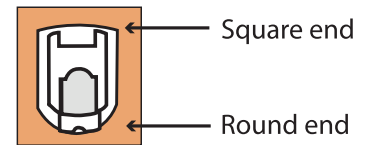

3. Use your other hand to guide the top of the valve. If the valve doesn't slide out easily, wiggle it from side to side and pull up to help loosen it.

When valve is free, place valve in trash receptacle.

CAUTION: SAUCE MAY SPLASH.

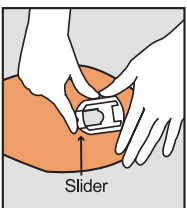

4. Take the opened, unused valve and insert it into the bag until it snaps tightly into place. Before placing the bag into the dispenser, open the slider valve and press down gently until all excess air is removed. Close the valve and place into the dispenser.

We strongly recommend activating the valve once per shift to keep from seizing.

Questions? Call 1(800)521-2873 or email help@gehlfoods.com

Always handle Gehl Foods' products in accordance with the store's local Food Code.